

AquaAmp

INSTALLATION INSTRUCTIONS DUAL USB-C CHARGER

PARTS PROVIDED

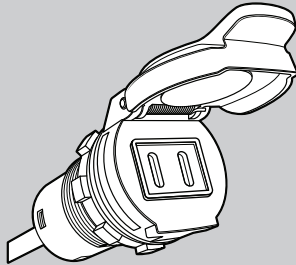

Dual USB-C Charger

TOOLS REQUIRED

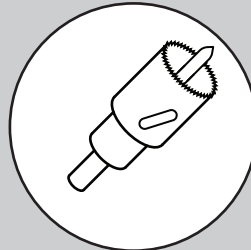

1 1/8" Hole Saw

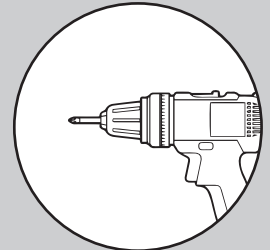

Electric Drill

INSTALLATION GUIDE

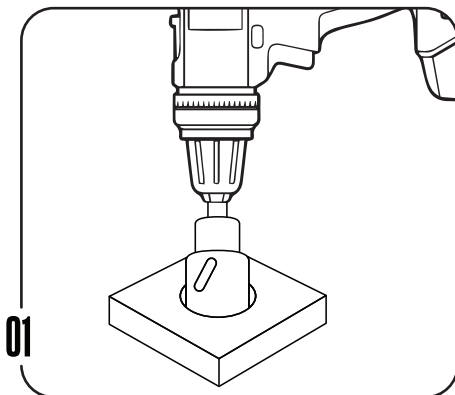

STEP 1: Drill or cut 1 1/8" hole.

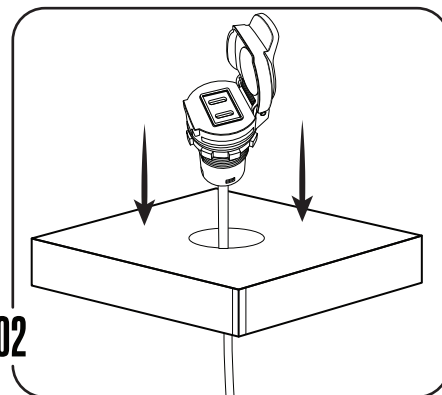

STEP 2: Insert charger into hole.

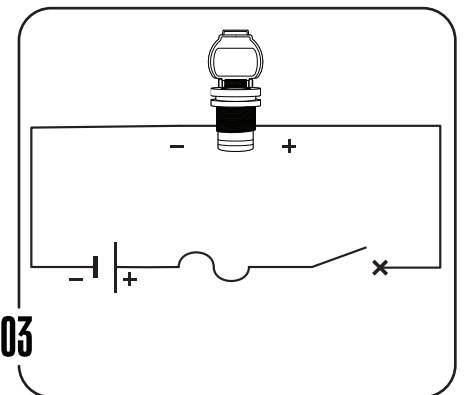

STEP 3: Using a 3A fuse, attach wires to a 12v power supply and ensure there is a waterproof connection.

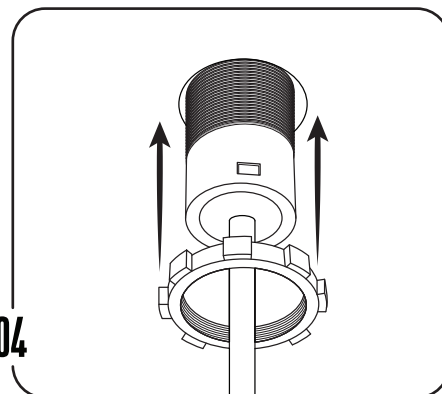

STEP 4: Firmly screw up the locknut.

CONTACT:

orders@aquaamp.com
13926 Monroes Business Park, Tampa, FL 33635

For further information visit www.aquaamp.com