

ITEM FORM

Elettrogas Aravon

Via Italia 1 - 28010 Caltignaga (Novara) www.aravon.it info@aravon.it Tel +39 (0)321 652838 Fax +39(0)321 652800

EAN code
803389162

066

Article Name **1521 Lux**

Describe Mixer (cold and hot water) in brass. Item specific for plastic or wood wall. It's necessary addition shower, flexible and item Ean316 or Ean352 for accross the wall.

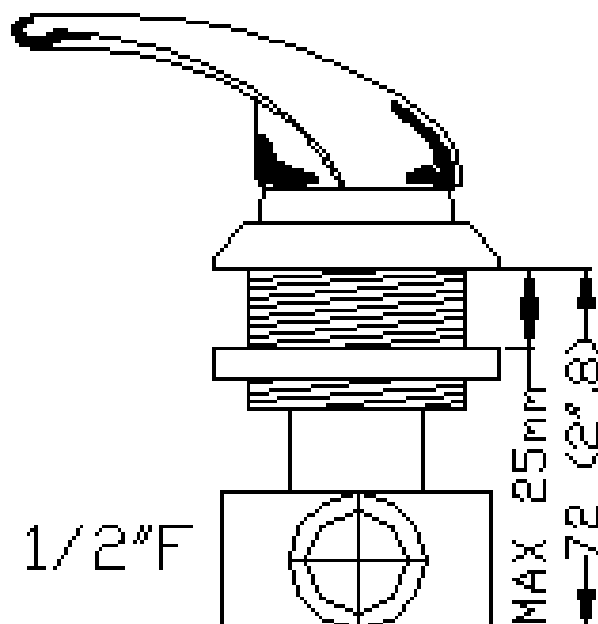

NOTES FOR DISTRIBUTOR

Type Of Packing White carton-box
Pcs ForBOX 0,288mc 32
Materials Cromed brass.

Distributor's
CODE

Photo Of Packages



Draw For Label

BODY IN BRASS
CERAMIK CARTR

FOR INSTALL:
REALIZED A
42mm HOLE

FOR CONNECT
USE #08AQC

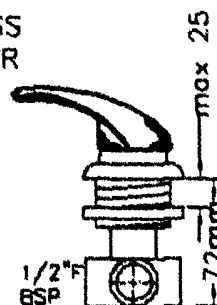

NOTES FOR SERVICE TECHNICIAN

Ingenier Notes

Hight quality. Cheramix mechanism for open/closed the flow. Connection 1/2" female nominal BSP. For guarantee the high quality, we verify the dimension size on all parts and every single piece is tested in pression to guarantee the perfect functionally.

Spare Parts

Cartridge Ean 523

Ean SimilarItems

Ean 057, 059, 068, 069, 176, 181, 182

Installing draw

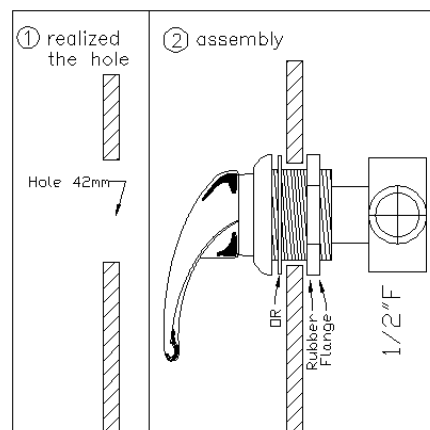

ITEM FORM

Elettrogas Aravon

Via Italia 1 - 28010 Caltignaga (Novara) www.aravon.it info@aravon.it Tel +39 (0)321 652838 Fax +39(0)321 652800

EAN code
803389162

176

Article Name 33 Lux

Describe Mixer (cold and hot water) in brass. Item specific for plastic or wood plan. It's necessary addition shower, flexible and item Ean352 for accross the plan.

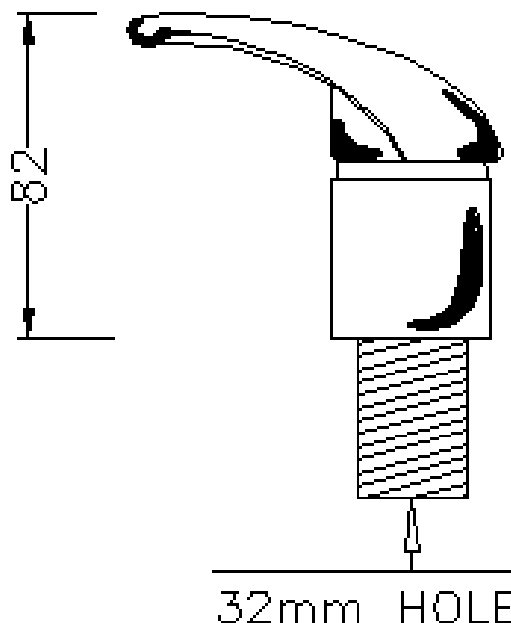

NOTES FOR DISTRIBUTOR

Type Of Packing White carton-box
Pcs ForBOX 0,288mc 32
Materials Cromed brass.

Distributor's CODE

Photo Of Packages



Draw For Label

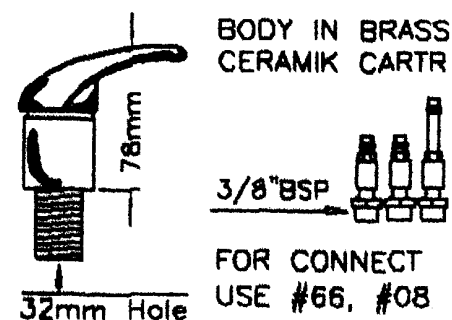

NOTES FOR SERVICE TECHNICIAN

Ingenier Notes

Hight quality. Cheramix mechanism for open/closed the flow. Connection 3/8" male nominal BSP. For guarantee the high quality, we verify the dimension size on all parts and every single piece is tested in pression to guarantee the perfect functionally.

Spare Parts

Cartridge Ean 523

Ean SimilarItems

Ean 181, 182, 066, 068, 069

Installing draw

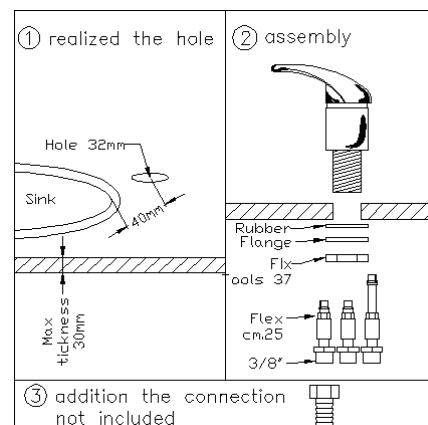

ITEM FORM

Elettrogas Aravon

Via Italia 1 - 28010 Caltignaga (Novara) www.aravon.it info@aravon.it Tel +39 (0)321 652838 Fax +39(0)321 652800

EAN code
803389162

185

Article Name 34C Lux

Describe Mixer (cold and hot water) in brass. Item specific for bath's sink

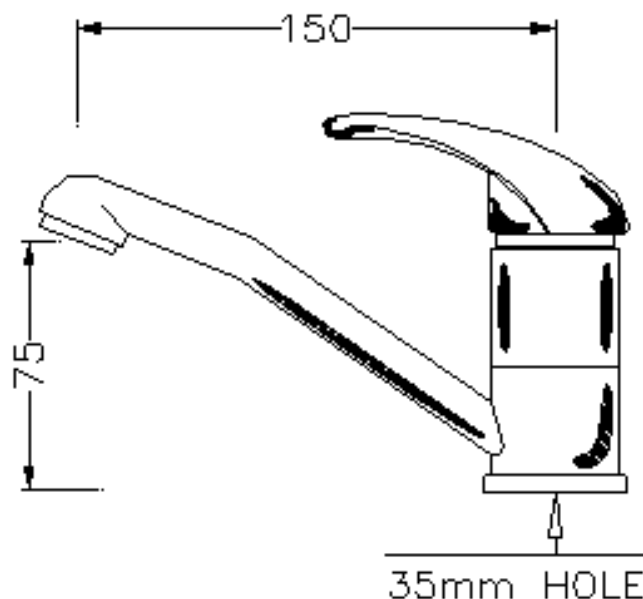

NOTES FOR DISTRIBUTOR

Type Of Packing White carton-box
Pcs ForBOX 0,288mc 27
Materials Cromed brass.

**Distributor's
CODE**

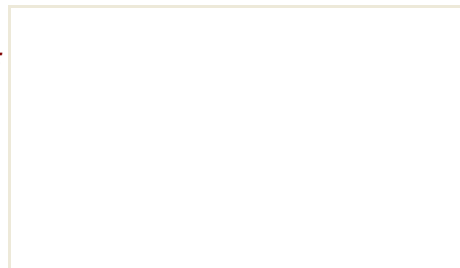
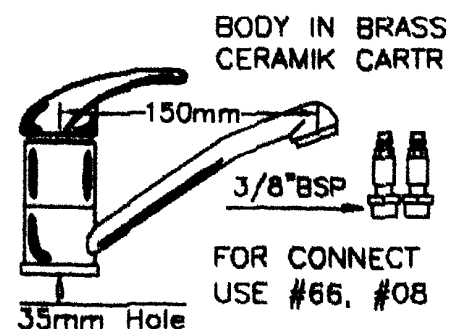

Photo Of Packages



Draw For Label



NOTES FOR SERVICE TECHNICIAN

Ingenier Notes

Hight quality. Cheramix mechanism for open/closed the flow. Connection 3/8" male nominal BSP. For guarantee the high quality, we verify the dimension size on all parts and every single piece is tested in presson to guarantee the perfect functionally.

Spare Parts

Cartridge Ean 523

Ean SimilarItems

Ean 191, 193, 287, 289, 291

Installing draw

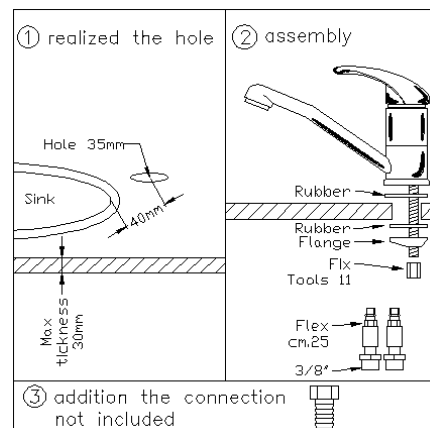

ITEM FORM

Elettrogas Aravon

Via Italia 1 - 28010 Caltignaga (Novara) www.aravon.it info@aravon.it Tel +39 (0)321 652838 Fax +39(0)321 652800

EAN code
803389162

199

Article Name 34L Lux

Describe Mixer (cold and hot water) in brass. Item specific for kitchen's sink.

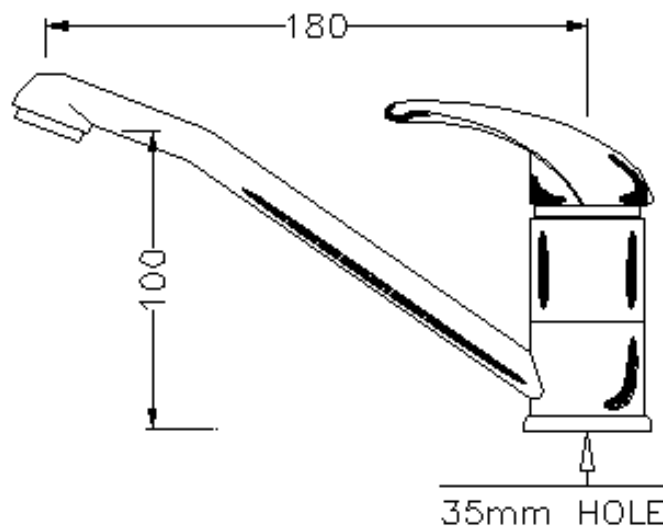

NOTES FOR DISTRIBUTOR

Type Of Packing White carton-box
Pcs ForBOX 0,288mc 27
Materials Cromed brass.

**Distributor's
CODE**

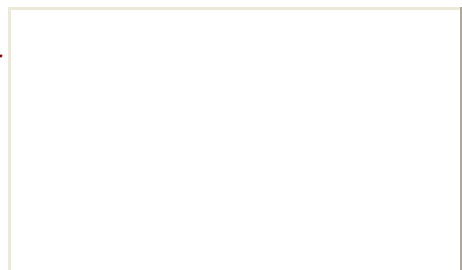
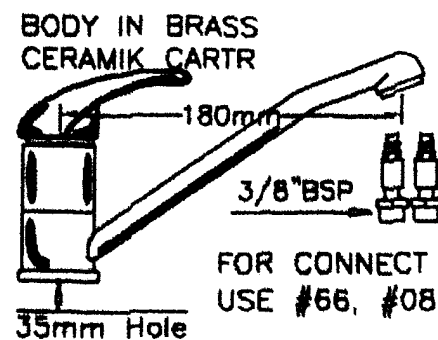

Photo Of Packages



Draw For Label



NOTES FOR SERVICE TECHNICIAN

Ingenier Notes

Hight quality. Cheramix mechanism for open/closed the flow. Connection 3/8" male nominal BSP. For guarantee the high quality, we verify the dimension size on all parts and every single piece is tested in pression to guarantee the perfect functionally.

Spare Parts

Cartridge Ean 523

Ean SimilarItems

Ean 208, 209, 296, 298, 299, 106, 109, 132, 224

Installing draw

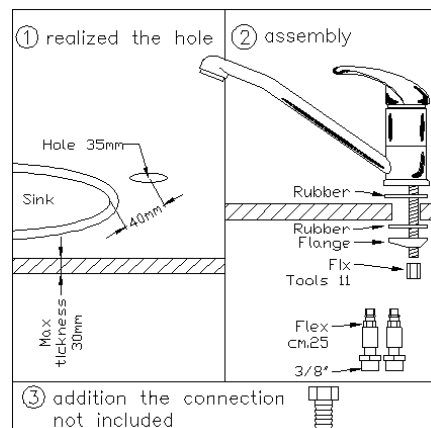

EAN code
803389162

246

Article Name 35Lux + 85white

Describe Mixer (cold and hot water) in brass with extraible shower and flexible long 200cm. Item specific for kitchen or bath's sink.

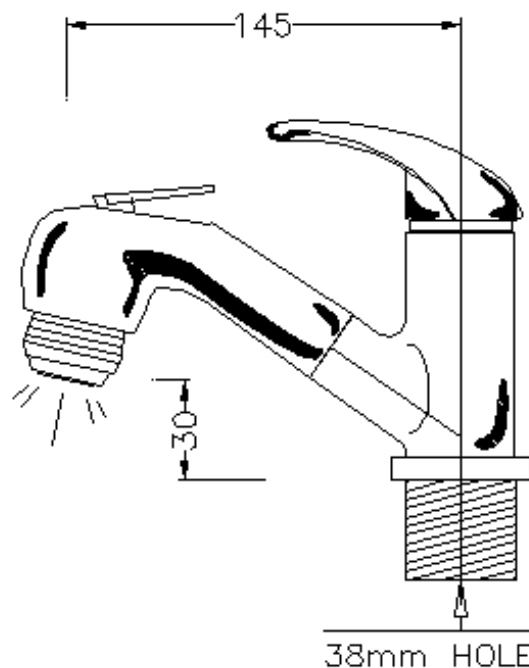

NOTES FOR DISTRIBUTOR

Type Of Packing White carton-box
Pcs ForBOX 0,288mc 12
Materials Cromed brass.

**Distributor's
CODE**

Photo Of Packages



Draw For Label

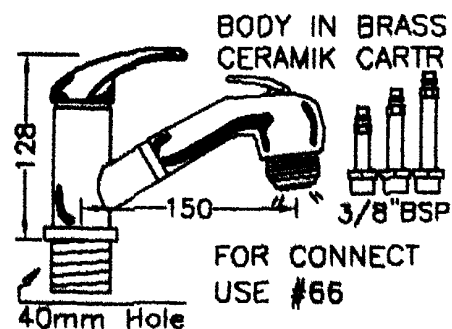

NOTES FOR SERVICE TECHNICIAN

Ingenier Notes

Hight quality. Cheramix mechanism for open/closed the flow. Connection 3/8" male nominal BSP. For guarantee the high quality, we verify the dimension size on all parts and every single piece is tested in pression to guarantee the perfect functionally.

Spare Parts

Cartridge Ean 523, shower Ean484, flexible Ean 401

Ean SimilarItems

from Ean 228 to Ean 268; 092, 137, 227

Installing draw

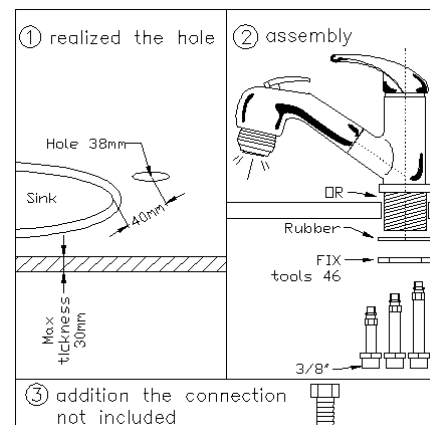

ITEM FORM

Elettrogas Aravon

Via Italia 1 - 28010 Caltignaga (Novara) www.aravon.it info@aravon.it Tel +39 (0)321 652838 Fax +39(0)321 652800

EAN code
803389162

270

Article Name 36 Lux Gir

Describe Mixer (cold and hot water) in brass. Item specific for flat-shower. It's necessary addition shower and flexible.

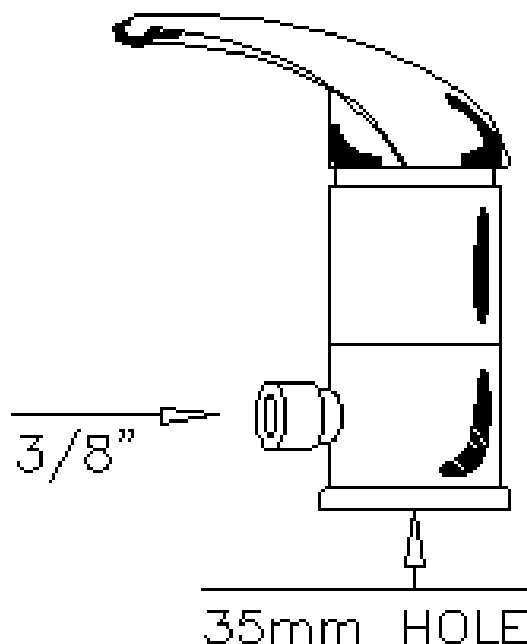

NOTES FOR DISTRIBUTOR

Type Of Packing White carton-box
Pcs ForBOX 0,288mc 27
Materials Cromed brass.

**Distributor's
CODE**

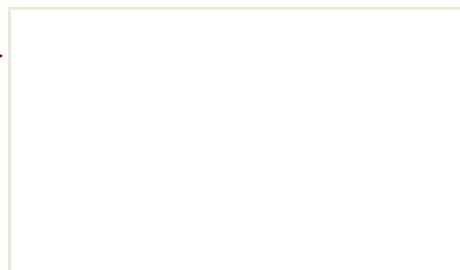
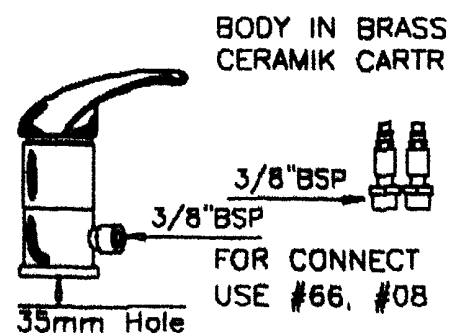

Photo Of Packages



Draw For Label



NOTES FOR SERVICE TECHNICIAN

Ingenier Notes

Hight quality. Cheramix mechanism for open/closed the flow. Connection 3/8" male nominal BSP. For guarantee the high quality, we verify the dimension size on all parts and every single piece is tested in pression to guarantee the perfect functionally.

Spare Parts

Cartridge Ean 523

Ean SimilarItems

Ean 274, 276, 059, 057

Installing draw

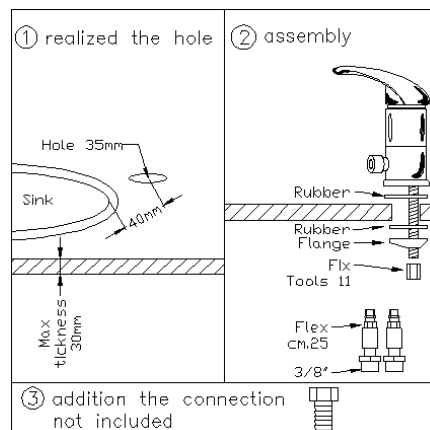

ITEM FORM

Elettrogas Aravon

Via Italia 1 - 28010 Caltignaga (Novara) www.aravon.it info@aravon.it Tel +39 (0)321 652838 Fax +39(0)321 652800

EAN code
803389162

287

Article Name **38 S Lux**

Describe Mixer (cold and hot water) in brass. Item specific for bath's sink.

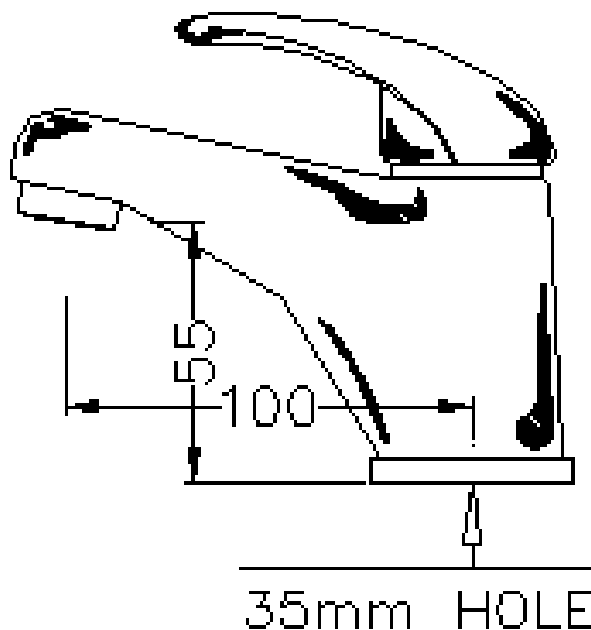

NOTES FOR DISTRIBUTOR

Type Of Packing White carton-box
Pcs ForBOX 0,288mc 27
Materials Cromed brass.

**Distributor's
CODE**

Photo Of Packages



Draw For Label

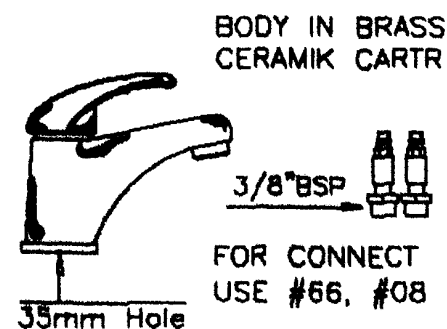

NOTES FOR SERVICE TECHNICIAN

Ingenier Notes

Hight quality. Cheramix mechanism for open/closed the flow. Connection 3/8" male nominal BSP. For guarantee the high quality, we verify the dimension size on all parts and every single piece is tested in pression to guarantee the perfect functionally.

Spare Parts

Cartridge Ean 524

Ean SimilarItems

Ean 289, 291, 185, 191, 193

Installing draw

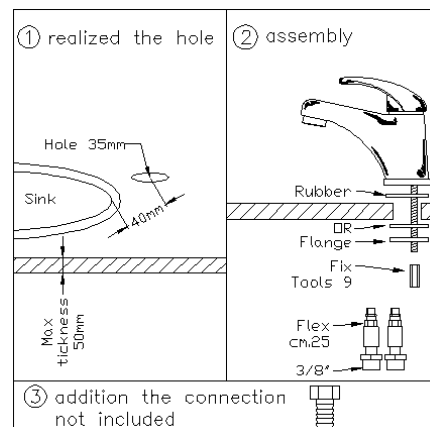

ITEM FORM

Elettrogas Aravon

Via Italia 1 - 28010 Caltignaga (Novara) www.aravon.it info@aravon.it Tel +39 (0)321 652838 Fax +39(0)321 652800

EAN code
803389162

296

Article Name 40 Lux

Describe Mixer (cold and hot water) in brass. Item specific for kitchen's sink.

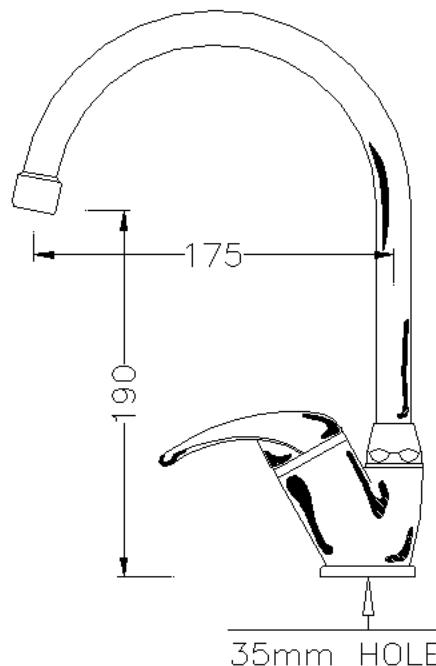

NOTES FOR DISTRIBUTOR

Type Of Packing White carton-box
Pcs ForBOX 0,288mc 12
Materials Cromed brass.

**Distributor's
CODE**

Photo Of Packages



Draw For Label

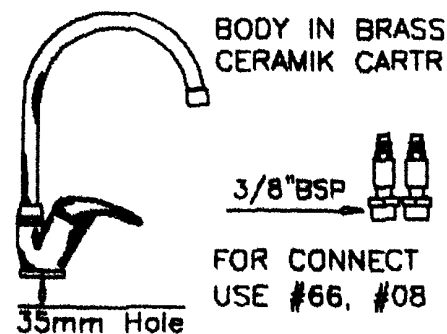

NOTES FOR SERVICE TECHNICIAN

Ingenier Notes

Hight quality. Cheramix mechanism for open/closed the flow. Connection 3/8" male nominal BSP. For guarantee the high quality, we verify the dimension size on all parts and every single piece is tested in pression to guarantee the perfect functionally.

Spare Parts

Cartridge Ean 523

Ean SimilarItems

Ean 298, 299, 106, 109, 085, 132, 224,

Installing draw

