

**PERFORMANCE:**

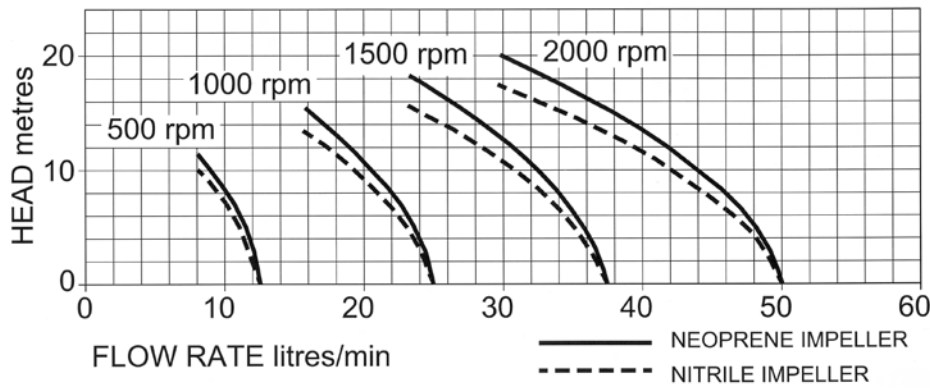

MODEL	Maximum flow rate		Maximum head	
	l/min	gall/min	metres	feet
<b>10550-200</b>	50	11	20	65
<b>10550-212</b>	50	11	17	55

Max power absorbed 550 watt at 2000rpm

**DIMENSIONS:**

**WEIGHT: 3Kg**

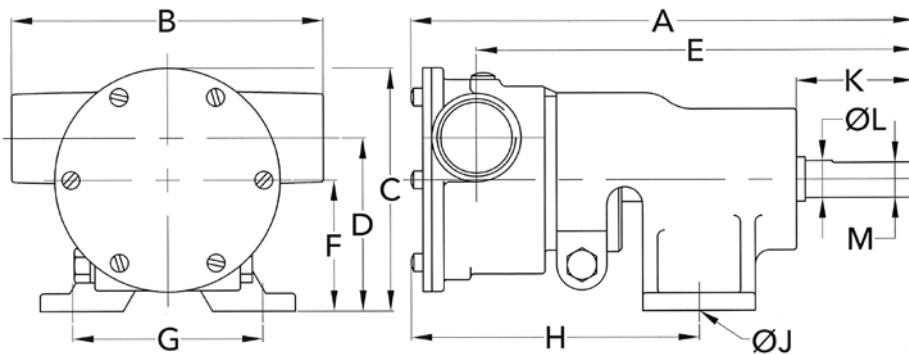

A	B	C	D	E	F	G	H	J	K	L	M
170	105	83	59	148	45	64	97	8.7	40	12.6	11.9

**MATERIALS OF CONSTRUCTION:**

<b>Body</b>	Bronze
<b>Impeller</b>	Neoprene or Nitrile
<b>Wearplate</b>	Replaceable
<b>Shaft</b>	Stainless steel type 316
<b>Shaft seal</b>	Lip type
<b>Bearings</b>	Twin single row, ball type
<b>Port type</b>	3/4" BSP to BS21 (DIN2999)

**MODELS:**

**10550-200** Standard Neoprene impeller

**10550-212** Oil resistant Nitrile impeller

**10550-237** High pressure Neoprene



a xylem brand

**BRONZE FLEXIBLE  
IMPELLER  
PEDESTAL PUMP  
10550 SERIES**



**PUMP with  
3/4" BSP PORTS**

- \* Constructed from marine quality bronze and stainless steel
- \* Self-prime from dry up to 2.4m
- \* Easy to service and maintain
- \* Will tolerate abrasive wear
- \* Handles hard and soft solids without clogging
- \* Can pump in either direction
- \* Will not airlock



Xylem Water Solutions UK Ltd  
Bingley Road • Hoddesdon • Hertfordshire • EN11 0BU • UK

Telephone: +44 (0)1462 480380 Fax: +44 (0)1462 482422  
mail@cleghorn.co.uk www.jabscoshop.com